



ELECTROFUSION COUPLER WITH BRASS TRANSITION SDR 11



water
16 bar



gas
10 bar



hydrogen
10 bar



PE 100-RC
material



MRS 10 MPa



threads according
to EN10266-1

MALE THREAD

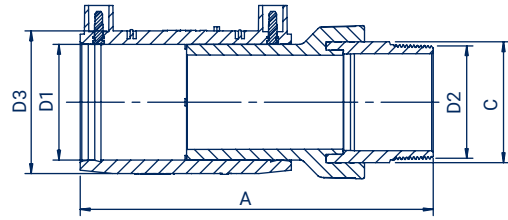

Size D1/D2 (mm)	Code	C (mm)	D3 (mm)	A (mm)	Weight (kg)	Packing
20 x 1/2"	MGZ020012	22	35	134	0,13	54
25 x 3/4"	MGZ025034	28	36	136	0,17	100
32 x 1"	MGZ032001	34	43	145	0,24	100
40 x 1"	MGZ040001	34	53	154	0,36	40
40 x 1 1/4"	MGZ040114	44	53	160	0,35	60
50 x 1 1/2"	MGZ050112	49	64	170	0,47	40
63 x 2"	MGZ063002	61	79	197	0,85	30
75 x 2 1/2"	MGZ075212	76	96	226	1,31	10
90 x 3"	MGZ090003	88	112	250	1,87	10
110 x 4"	MGZ110004	114	134	276	3,05	6
125 x 4"	MGZ125004	114	152	280	3,34	6

FEMALE THREAD

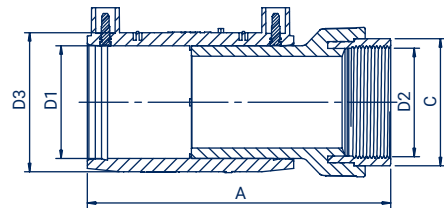

Size D1/D2 (mm)	Code	C (mm)	D3 (mm)	A (mm)	Weight (kg)	Packing
20 x 1/2"	MGW020012	26	35	120	0,13	54
25 x 3/4"	MGW025034	32	36	121	0,14	50
32 x 1"	MGW032001	40	43	126	0,19	35
40 x 1"	MGW040001	40	53	135	0,24	100
40 x 1 1/4"	MGW040114	48	53	143	0,28	60
50 x 1 1/2"	MGW050112	55	64	150	0,39	50
63 x 2"	MGW063002	67	79	173	0,59	30
75 x 2 1/2"	MGW075212	83	96	198	1,00	10
90 x 3"	MGW090003	96	112	222	1,47	10
110 x 4"	MGW110004	122	134	239	2,20	8
125 x 4"	MGW125004	122	152	244	2,49	6