



# PE / BRASS TRANSITION SDR 11



**water**  
16 bar



**gas**  
10 bar



**hydrogen**  
10 bar



**PE 100-RC**  
material



**MRS 10 MPa**



**threads according**  
to EN10266-1

MALE THREAD |

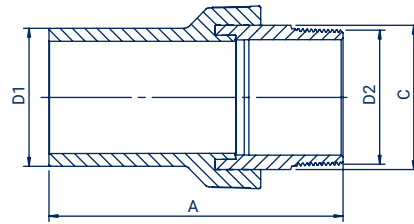

Size D1/D2 (mm)	Code	C (mm)	A (mm)	Weight (kg)	Packing
20 x 1/2"	AGZ020012	22	91	0,08	220
25 x 3/4"	AGZ025034	28	93	0,12	200
32 x 1"	AGZ032001	34	102	0,17	140
40 x 1"	AGZ040001	34	107	0,16	140
40 x 1 1/4"	AGZ040114	44	113	0,28	100
50 x 1 1/2"	AGZ050112	49	123	0,36	70
63 x 2"	AGZ063002	61	139	0,67	40
75 x 2 1/2"	AGZ075212	76	158	0,96	25
90 x 3"	AGZ090003	88	175	1,40	18
110 x 4"	AGZ110004	114	196	2,35	8
125 x 4"	AGZ125004	114	196	2,44	6

FEMALE THREAD |

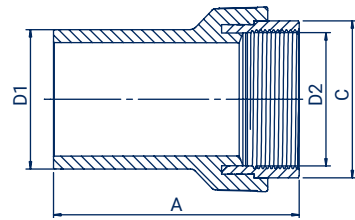

Size D1/D2 (mm)	Code	C (mm)	A (mm)	Weight (kg)	Packing
20 x 1/2"	AGW020012	26	77	0,07	200
25 x 3/4"	AGW025034	32	78	0,09	60
32 x 1"	AGW032001	40	83	0,14	200
40 x 1"	AGW040001	40	88	0,16	140
40 x 1 1/4"	AGW040114	48	96	0,20	100
50 x 1 1/2"	AGW050112	55	103	0,29	84
63 x 2"	AGW063002	67	115	0,41	50
75 x 2 1/2"	AGW075212	83	130	0,65	32
90 x 3"	AGW090003	96	147	1,02	20
110 x 4"	AGW110004	122	160	1,50	8
125 x 4"	AGW125004	122	160	1,59	6