



# BRANCH SADDLE UNIVERSAL SDR 11



water  
16 bar



gas  
10 bar



hydrogen  
10 bar



PE 100-RC  
material



MRS 10 MPa

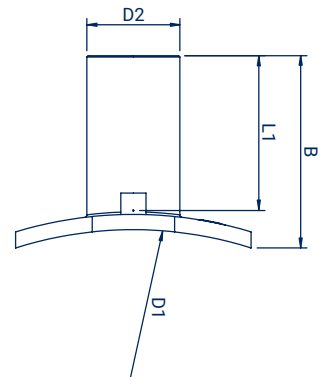
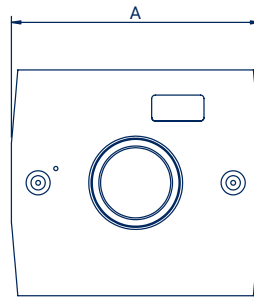

Size D1/D2 (mm)	Code	A (mm)	B (mm)	L1 (mm)	Weight (kg)	Packing
355-560/63	OE35556006311	210	165	112	0,82	20
355-560/75	OE35556007511	210	165	112	0,86	20
355-560/90	OE35556009011	210	165	112	0,88	12
355-560/110	OE35556011011	210	165	112	1,00	12
630-900/63	OE63090006311	209	155	110	0,59	20
630-900/75	OE63090007511	209	155	110	0,69	16
630-900/90	OE63090009011	209	155	110	0,70	16
630-900/110	OE63090011011	209	155	110	0,87	16

## FOXGRIP CLAMPING TOOL



Pipe diameter (mm)	Code
355	FSGRIP355110
400	FSGRIP400110
450	FSGRIP450110
500	FSGRIP500110
560	FSGRIP560110
630	FSGRIP630110
710	FSGRIP710110
800	FSGRIP800110
900	FSGRIP900110



**PERFECT FITTING**  
of the saddle to the  
pipe curvature

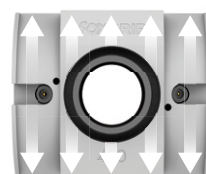

**EVEN PRESSURE**  
around the entire  
circumference of the saddle