

### Types of carriageway surface construction

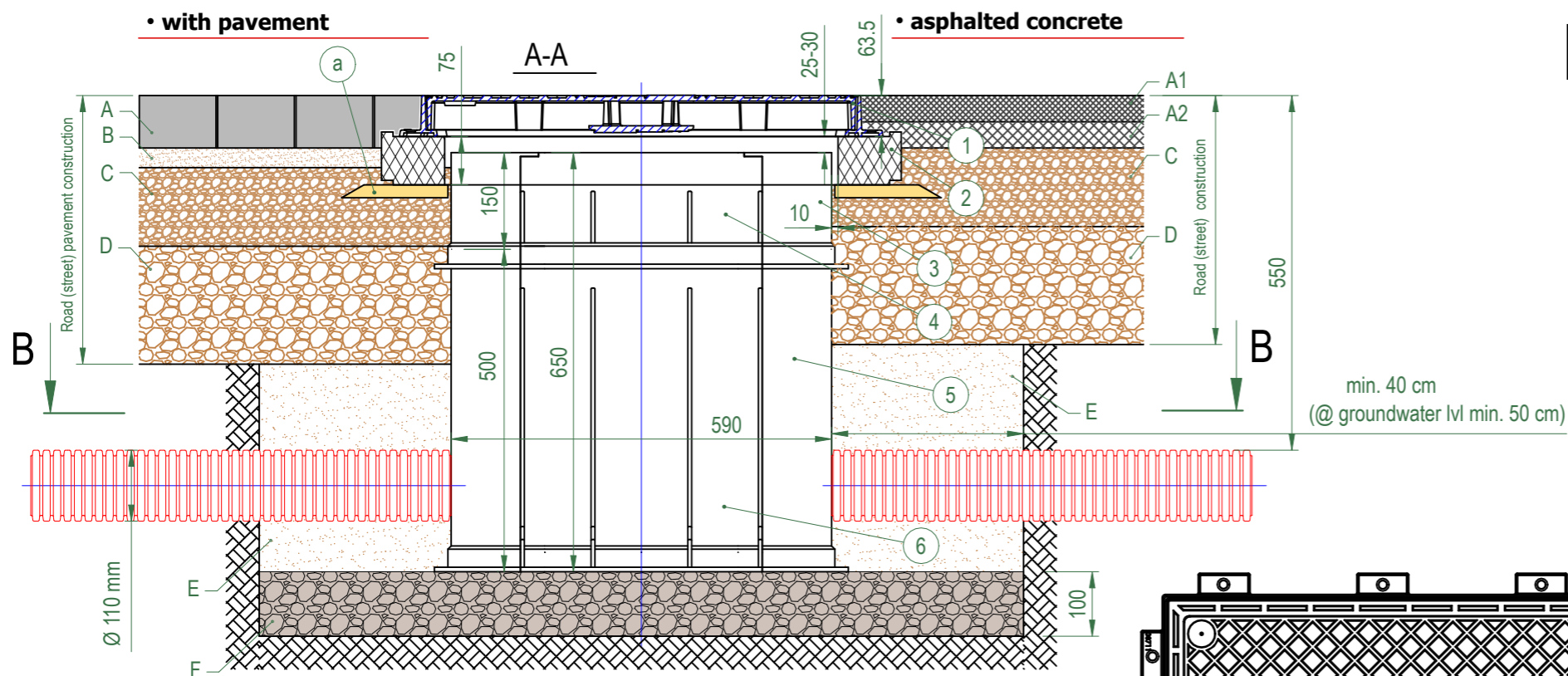

# Radbox 450 x 450

Intended for construction in a Group 2 area in accordance with EN 124-1 (class B125).

No.	Description
A	Concrete paving stone, h=8cm
A1	Asphalt Concrete ABT 16, h=4cm
A2	Asphalt Concrete AG 22, h=4cm
B	Sand levelling layer, h=3cm
C	Dolomite chips (fraction size 20-40mm), h=12cm
D	Dolomite chips (fraction size 40-70mm), h=18cm
E	Sand (coef. Kf>1m/dnn) in all trench depth
F	Dolomite chips* (fraction size 20-40mm), h=10cm

\* Compaction according to the Standard Proctor Density Scale (SPD) < 98%

### Griezums B-B

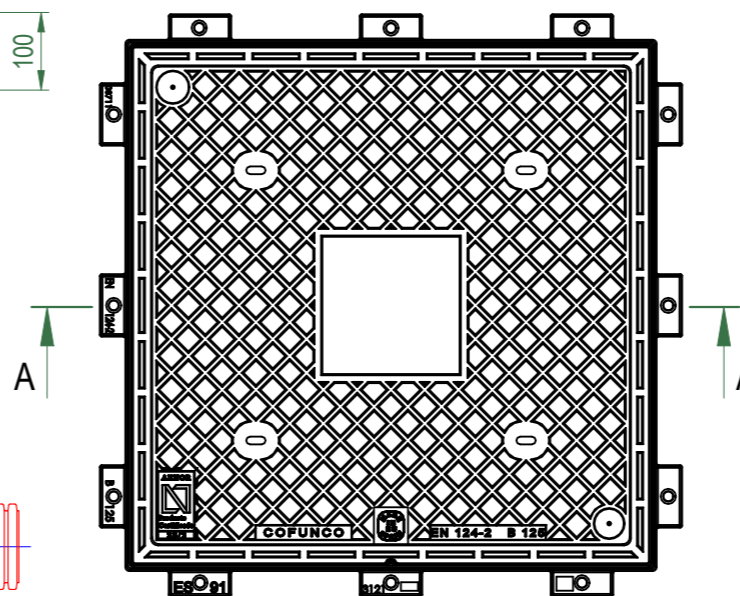
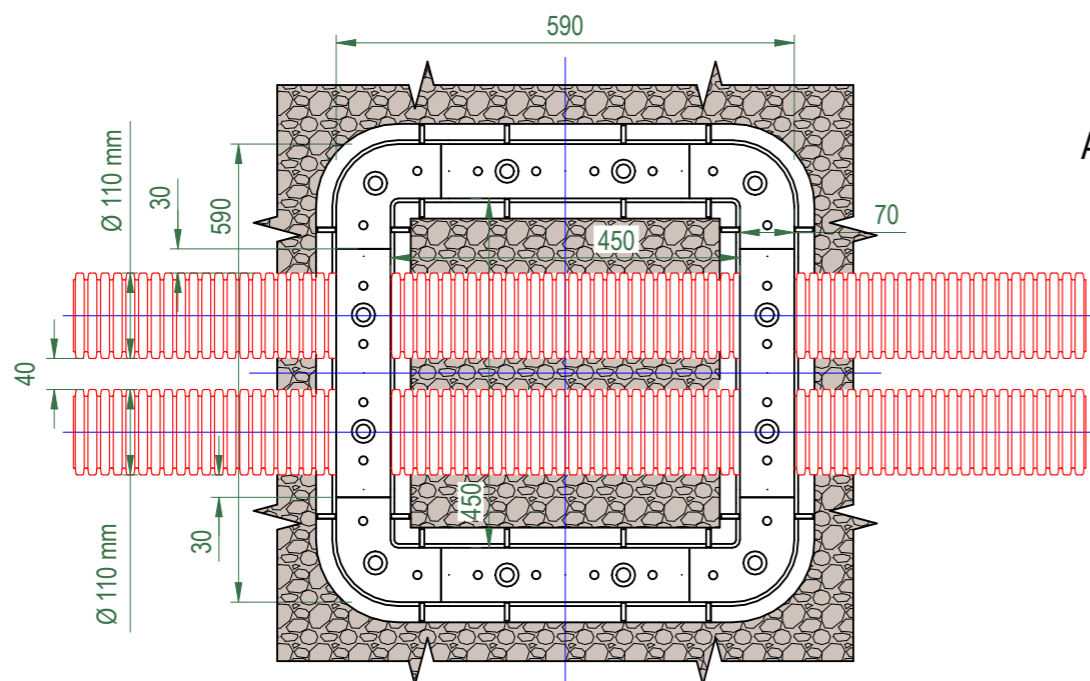

No.	Part	Description	Pcs.
1	Chamber cover (EN 124-2), B125 class	Opening 632x632 mm	1
2	Polymer support ring, h=75 mm	Internal size - 610x610 mm External size - 770x770 mm	1
3	Radbox corner	h=150 mm	4
4	Radbox wall 450	h=150 mm	4
5	Radbox corner	h=500 mm	4
6	Radbox wall 450	h=500 mm	4

#### NOTES:

- This solution is designed for a construction zone with a maximum load class B125.
- The construction of the Radbox shall be carried out in accordance with the requirements of EN 13598-2.
- The Radbox can be fitted with a 12 mm thick base bolted to the walls (the base does not ensure airtightness).
- Cable duct supports are available on request and can be mounted on the walls.

This drawing is the intellectual property of Evopipes SIA

**(a) AN EXAMPLE OF GOOD PRACTICE**  
It is recommended to create a small, point-load-resistant base area under the support ring (e.g. fine crushed stone, sand or mortar concrete).



SIA "EVOPIPES"  
Langervaldes street 2a, Jelgava, LV-3002, Latvia  
Reg. No.: 50003728871  
Phone: +371 63094300  
e-mail: [info@evopipes.lv](mailto:info@evopipes.lv)  
Homepage: [www.evopipes.lv](http://www.evopipes.lv)

FILE NAME:  
RadBox.H=650mm.EN124-2-B125.dwg

PAGE: 1 from 1

PAGE FORMAT: @ A4

SCALE:  
WITHOUT SCALE

TYPE:  
STANDARD DRAWING