

# CHAMBERS SYSTEMS WITH SEDIMET TRAP

## DN400.315.D400.S.OD.SM.PIPE

| DRAWING No.:                | VERSION | REVISION | REVISION STATUS |
|-----------------------------|---------|----------|-----------------|
| DN400.315.D400.S.OD.SM.PIPE | EN      | 1        | ACTUAL          |

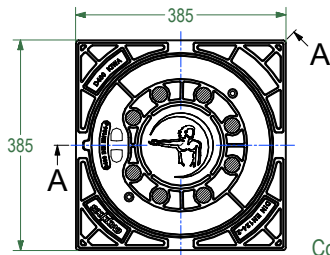

Cover class D400  
acc. to EN 124-2

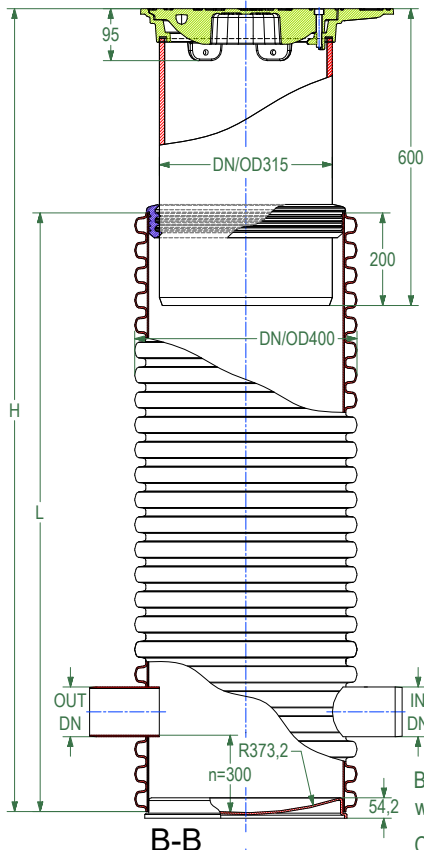

PP DN/OD, EN 13476-2,  
EN 1852-1, EN 14758-1

By default sediment trap height is (n=300 mm),  
with functional volume of 28,8 l=28,8 dm<sup>3</sup>

On demand sediment trap can be  
manufactured with specified height.

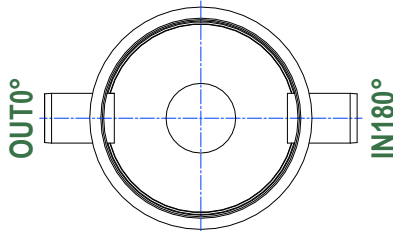
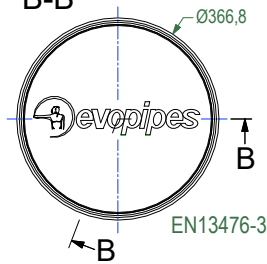

**OUT0° / IN180°**  
DN110, 160, 200, 250, 315 mm

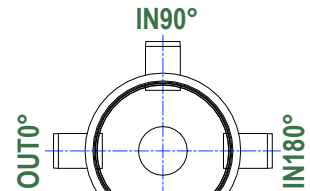

**IN270°**

**OUT0° / IN90° / IN180° IN270°**  
DN110, 160, 200, 250 mm

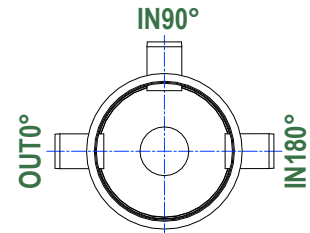

**OUT0° / IN90° / IN180°**  
DN110, 160, 200, 250 mm

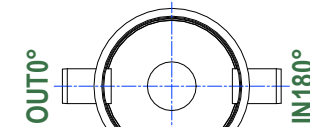

**IN270°**

**OUT0° / IN180° IN270°**  
DN110, 160, 200, 250 mm

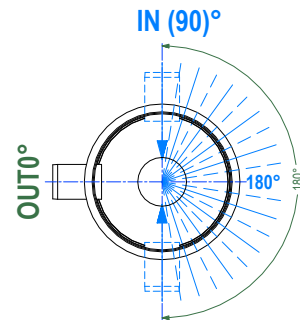

**IN (270°)**

**OUT0° / IN(90 - 270°)**  
DN110, 160, 200, 250 mm

IN - requested connection in desirable angle

*This drawing is not suitable for the design and construction of other objects without the consent of SIA "EVOPIPES"*



SIA "EVOPIPES"  
Langvaldes str. 2a, Jelgava, LV-3002, Latvia  
Company reg. No.: 50003728871  
Phone: +371 63094300  
E-mail: [info@evopipes.lv](mailto:info@evopipes.lv)  
Website: [www.evopipes.lv](http://www.evopipes.lv)

FILE NAME:  
DN400.315.D400.S.OD.SM.PIPE

SHEET: 1 OF 1

SHEET FORMAT: @A4

SCALE:  
NOT TO SCALE

STAGE:  
STANDARD DRAWING

# CHAMBERS SYSTEMS WITH SEDIMET TRAP

## DN400.315.D400.S.OD.PR.PIPE

| DRAWING No.:                | VERSION | REVISION | REVISION STATUS |
|-----------------------------|---------|----------|-----------------|
| DN400.315.D400.S.OD.PR.PIPE | EN      | 1        | ACTUAL          |

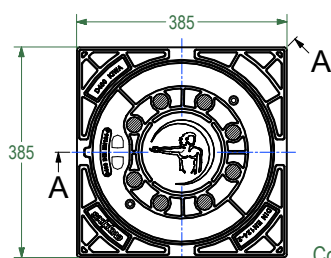

Cover class D400  
acc. to EN 124-2

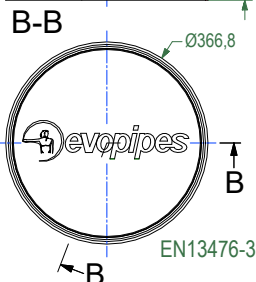
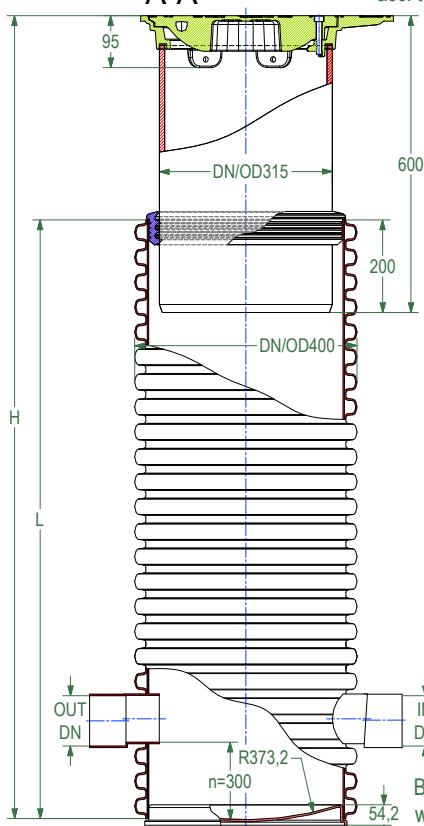

By default sediment trap height is (n=300 mm),  
with functional volume of 28,8 l=28,8 dm<sup>3</sup>  
On demand sediment trap can be  
manufactured with specified height.

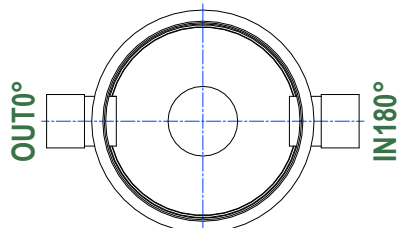

**OUT0° / IN180°**  
DN110, 160, 200, 250, 315 mm

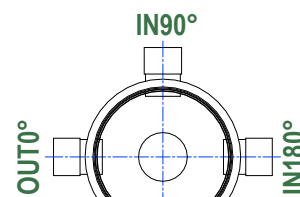

**IN270°**  
**OUT0° / IN90° / IN180° IN270°**  
DN110, 160, 200, 250 mm

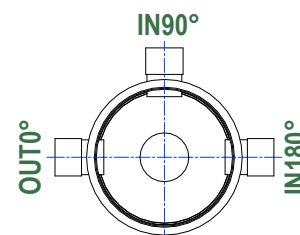

**OUT0° / IN90° / IN180°**  
DN110, 160, 200, 250 mm

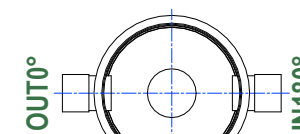

**IN270°**  
**OUT0° / IN180° IN270°**  
DN110, 160, 200, 250 mm

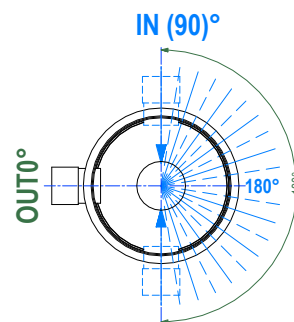

**IN (270°)**  
**OUT0° / IN(90 - 270°)**  
DN110, 160, 200, 250 mm  
**IN - requested connection in desirable angle**

*This drawing is not suitable for the design and construction of other objects without the consent of SIA "EVOPIPES"*



SIA "EVOPIPES"  
Langvaldes str. 2a, Jelgava, LV-3002, Latvia  
Company reg. No.: 50003728871  
Phone: +371 63094300  
E-mail: [info@evopipes.lv](mailto:info@evopipes.lv)  
Website: [www.evopipes.lv](http://www.evopipes.lv)

FILE NAME:  
DN400.315.D400.S.OD.PR.PIPE

SHEET: 1 OF 1

SHEET FORMAT: @ A4

SCALE:  
NOT TO SCALE

STAGE:  
STANDARD DRAWING

# CHAMBERS SYSTEMS WITH SEDIMET TRAP

| DRAWING No.:                | VERSION | REVISION | REVISION STATUS |
|-----------------------------|---------|----------|-----------------|
| DN400.315.D400.R.OD.SM.PIPE | EN      | 1        | ACTUAL          |

## DN400.315.D400.R.OD.SM.PIPE

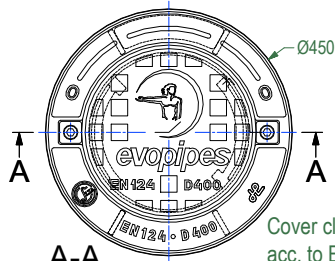

Cover class D400  
acc. to EN 124-2

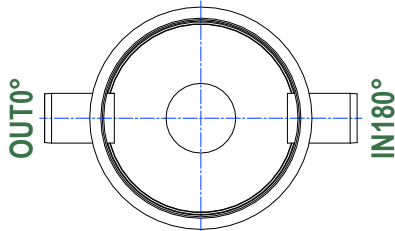
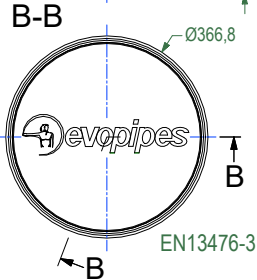
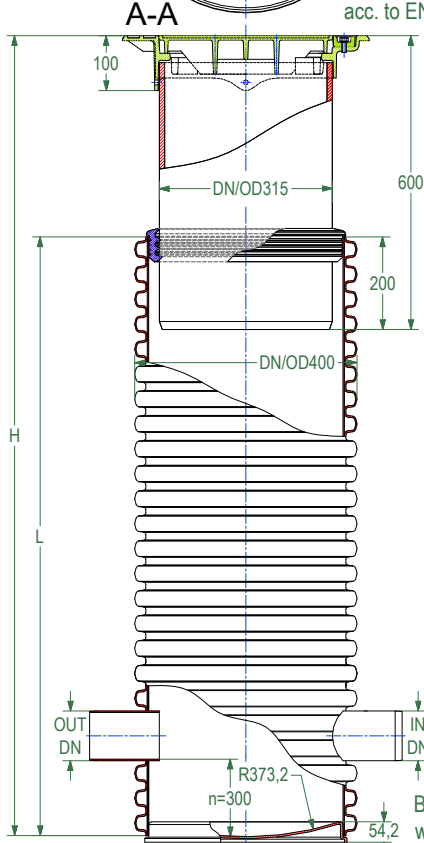

**OUT0° / IN180°**  
DN110, 160, 200, 250, 315 mm

PP DN/OD, EN 13476-2,  
EN 1852-1, EN 14758-1

By default sediment trap height is (n=300 mm),  
with functional volume of 28,8 l=28,8 dm<sup>3</sup>

On demand sediment trap can be  
manufactured with specified height.

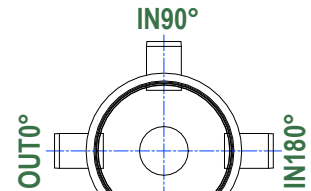

**IN270°**

**OUT0° / IN90° / IN180° IN270°**  
DN110, 160, 200, 250 mm

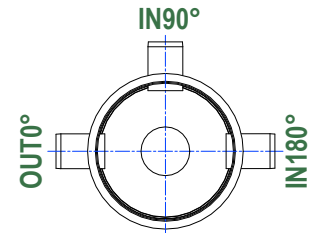

**OUT0° / IN90° / IN180°**  
DN110, 160, 200, 250 mm

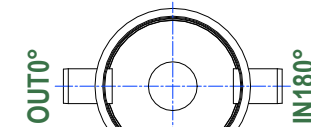

**IN270°**

**OUT0° / IN180° IN270°**  
DN110, 160, 200, 250 mm

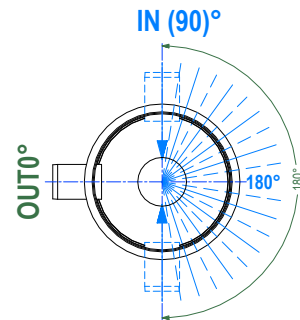

**IN (270°)**  
**OUT0° / IN(90° - 270°)**  
DN110, 160, 200, 250 mm

IN - requested connection in desirable angle

*This drawing is not suitable for the design and construction of other objects without the consent of SIA "EVOPIPES"*



SIA "EVOPIPES"  
Langervaldes str. 2a, Jelgava, LV-3002, Latvia  
Company reg. No.: 50003728871  
Phone: +371 63094300  
E-mail: [info@evopipes.lv](mailto:info@evopipes.lv)  
Website: [www.evopipes.lv](http://www.evopipes.lv)

FILE NAME:  
DN400.315.D400.R.OD.SM.PIPE

SHEET: 1 OF 1

SHEET FORMAT: @A4

SCALE:  
NOT TO SCALE

STAGE:  
STANDARD DRAWING

# CHAMBERS SYSTEMS WITH SEDIMET TRAP

| DRAWING No.:                | VERSION | REVISION | REVISION STATUS |
|-----------------------------|---------|----------|-----------------|
| DN400.315.D400.R.OD.PR.PIPE | EN      | 1        | ACTUAL          |

## DN400.315.D400.R.OD.PR.PIPE

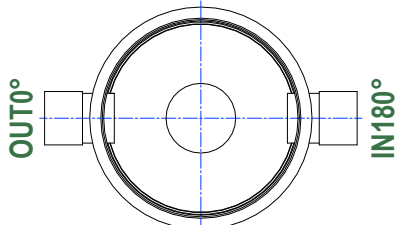
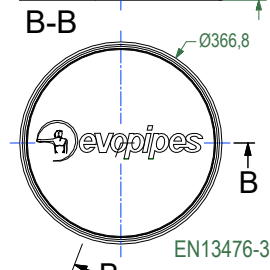
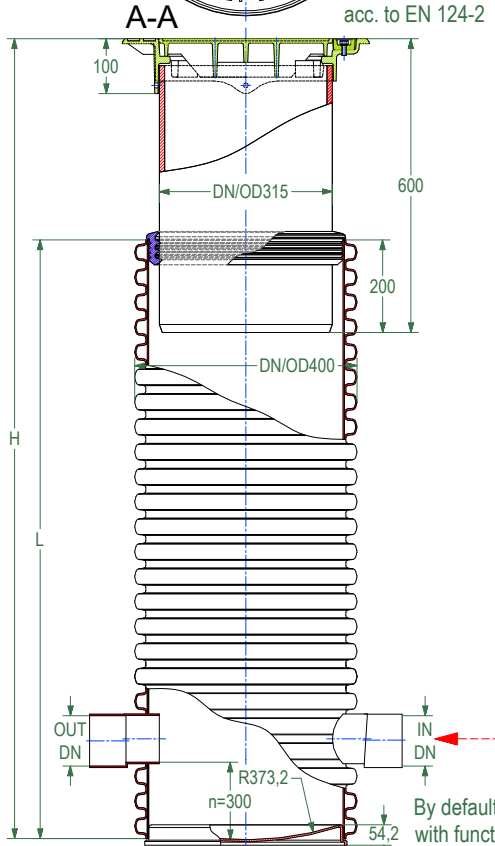
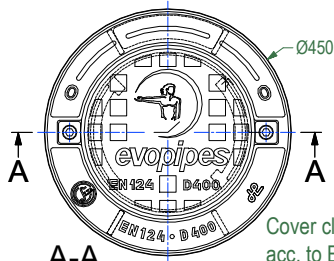

**OUT0° / IN180°**  
DN110, 160, 200, 250, 315 mm

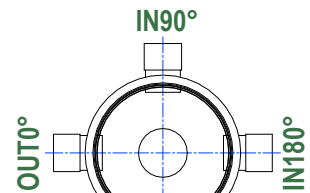

**IN270°**  
**OUT0° / IN90° / IN180° IN270°**  
DN110, 160, 200, 250 mm

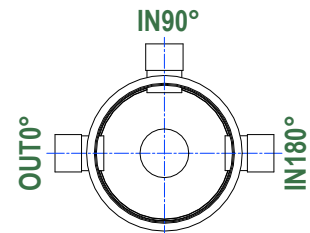

**OUT0° / IN90° / IN180°**  
DN110, 160, 200, 250 mm

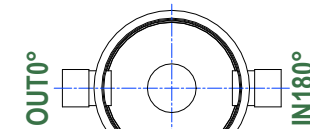

**IN270°**  
**OUT0° / IN180° IN270°**  
DN110, 160, 200, 250 mm

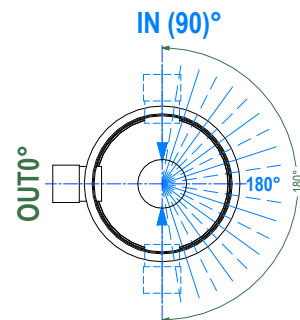

**IN (270°)**  
**OUT0° / IN(90 - 270°)**  
DN110, 160, 200, 250 mm  
**IN - requested connection in desirable angle**

*This drawing is not suitable for the design and construction of other objects without the consent of SIA "EVOPIPES"*



SIA "EVOPIPES"  
Langervaldes str. 2a, Jelgava, LV-3002, Latvia  
Company reg. No.: 50003728871  
Phone: +371 63094300  
E-mail: [info@evopipes.lv](mailto:info@evopipes.lv)  
Website: [www.evopipes.lv](http://www.evopipes.lv)

FILE NAME:  
DN400.315.D400.R.OD.PR.PIPE

SHEET: 1 OF 1

SHEET FORMAT: @A4

SCALE:  
NOT TO SCALE

STAGE:  
STANDARD DRAWING